

Quick start guide – washing operations

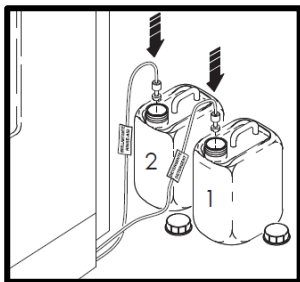

Check detergent and rinse-aid levels

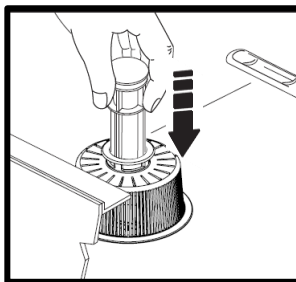

Make sure drainpipe and filter are correctly installed

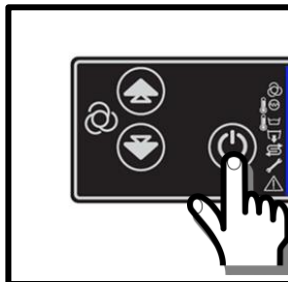

Switch on by a long pressing of ON/OFF button

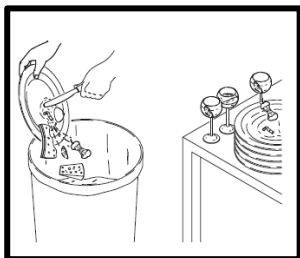

Remove any residual food from the dishes

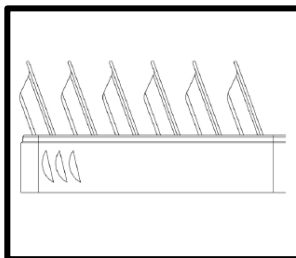

soup plates must be placed in the wide grid

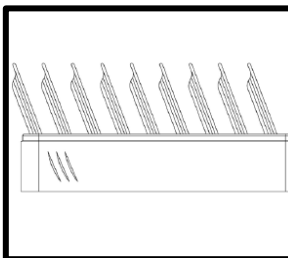

flat plates must be placed in the narrow grid



Wait for wash temperature reaches 66°C (150°F) and read READY on the display



Press arrow UP or arrow DOWN to select the property cycle



Press START to start the washing cycle.
Wash cycle is complete when the display shows "END" and starts to blink

End of service

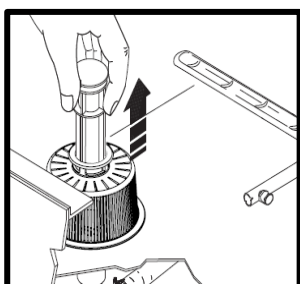

Open the door and remove the drainpipe

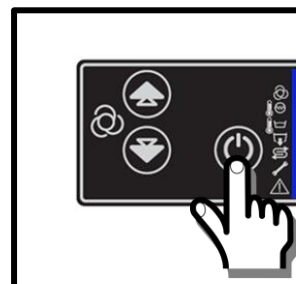

WITHOUT DRAIN PUMP
Briefly press the ON/OFF button to switch the dishwasher off

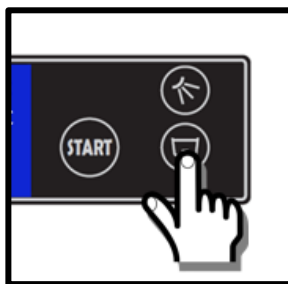

WITH DRAIN PUMP BUILT-IN
Press and hold the DRAIN button until the tank drain and self-cleaning cycle starts. At the end of the cycle the dishwashers turns off

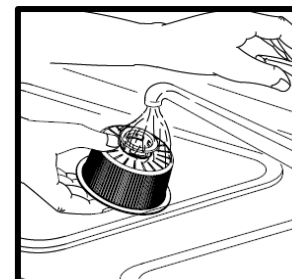
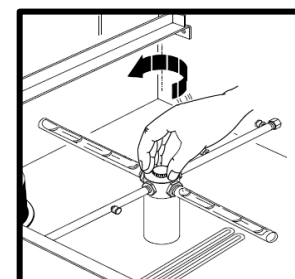
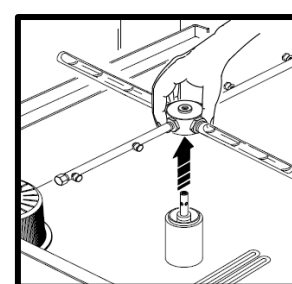
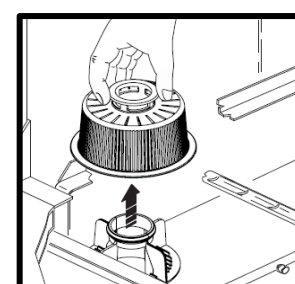

WHEN TANK IS EMPTY, REMOVE ALL FILTERS AND THE WASH ARMS BY UNSCREWING THE RETAINING NUT AND WASH THEM